

# ADEX MFO-A05P, A05R

Individual Connector Type Manifold  
Bar Type

## MFC□-A05P

Compact | Common SUP, common exhaust, ports 2 & 4 on the side

## MFS□-A05P

Common SUP, common exhaust, ports 2 & 4 on the side

## MFX□-A05P

Common SUP, common exhaust, common external pilot, ports 2 & 4 on the side

## MFU□-A05R

Common SUP, common exhaust, ports 2 & 4 on the body

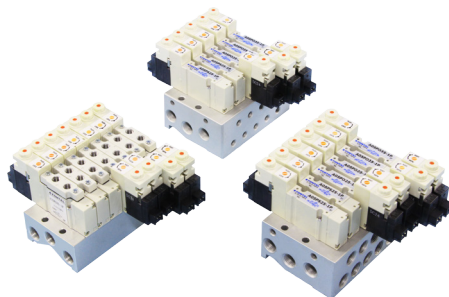

## Manifold Specifications

Type of manifold		For A05P Series			For A05R Series
		MFC□-A05P	MFS□-A05P	MFX□-A05P	MFU□-A05R
		Common SUP, common exhaust, pilot valve captured exhaust, ports 2 & 4 on the side	Common SUP, common exhaust, pilot valve captured exhaust, ports 2 & 4 on the side	Common SUP, common exhaust, common external pilot, pilot valve captured exhaust, ports 2 & 4 on the side	Common SUP, common exhaust, pilot valve captured exhaust, ports 2 & 4 on valve body
Port size	Ports 1, 3, 5	Rc $\frac{1}{8}$	Rc $\frac{1}{8}$	Rc $\frac{1}{8}$	Rc $\frac{1}{8}$
	Ports 2, 4	M5	Rc $\frac{1}{8}$	Rc $\frac{1}{8}$	M5
	Port Y	—	—	M5	—
	Port X	—	—	M5	—
Number of stations		2~20			
Installation		Direct mount			
Mountable solenoid valve		A05PS25 A05PD25 A05PD35 A05PE35 A05PO35	A05PS25 A05PD25 A05PD35 A05PE35 A05PO35	A05PS25X A05PD25X A05PD35X A05PE35X A05PO35X	A05RS25 A05RD25 A05RD35 A05RE35 A05RO35
Blank plate		A05P-BP			A05R-BP



### Tagging method

- Specify the type and number of manifolds and solenoid valves, as well as number of blank plate if needed.

## Manifold for A05P Series

## Type of manifold

**MFC:**  
Compact | Common SUP,  
common exhaust, ports 2 & 4  
on the side

**MFS:**  
Common SUP, common  
exhaust, ports 2 & 4 on the  
side

**MFx:**  
Common SUP, common  
exhaust, common external  
pilot, ports 2 & 4 on the side

## Mountable solenoid valve series

A05P

## Number of stations

2 : 2 station  
:  
:  
20 : 20 station

## Option 1

B : bracket  
No tag : without bracket  
(Note)

Those with brackets can  
only be used as single  
solenoid. Those installed  
on MFC, MFS type are  
mountable.

## Port size 2, 4

M5: M5  
01: Rc $\frac{1}{8}$

Type	M5	01
MFC	○	—
MFS	—	○
MFx	—	○

(Note)when using G, NPT, NPTF threads,  
please consult FONTAL first

## Mountable solenoid valve

A05P

S25

1

P

E

## Switch Form

## S25

2-position, single solenoid

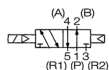

## D25

2-position, double solenoid

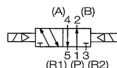

## D35

3-position, closed center



## E35

3-position, ABR connect

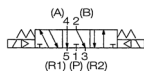

## O35

3-position, PAB connect

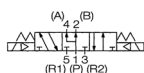

## Wiring

No mark: Without connector

E : Connector with wire  
(Length: 500 mm)

## Port size 2, 4

No mark: Without sub-base  
(Valve without sub-base comes with a base  
gasket & two mounting screws)

## Wiring withdrawal direction

## P:

With indicator light and  
surge suppressor

## S:

Without indicator light  
and surge suppressor

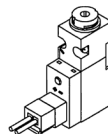
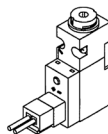

## Voltage

- 1: DC24V
- 2: ※DC12V
- 3: ※DC6V
- 4: ※DC5V
- 5: ※DC3V
- 7: ※AC100V
- 8: AC110V



※: Made to order

## Special Specification

No mark: standard (Internal pilot)

X : ※External pilot

(Note)Only when it is mounted on MFx,  
external pilot can be used.

## Manifold for A05R Series

## Type of manifold

MFU:  
Common SUP, common  
exhaust, ports 2 & 4 on the  
valve body

## Mountable solenoid valve series

A05R

## Number of stations

2 : 2 station  
: :  
20 : 20 station

Port 2&4

M5 : M5

## Mountable solenoid valve

## Switch Form

## S25

2-position, single solenoid

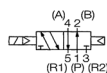

## D25

2-position, double solenoid

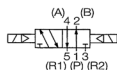

## D35

3-position, closed center



## E35

3-position, ABR connect

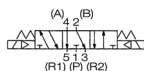

## O35

3-position, PAB connect

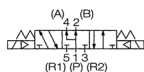

## For mounting on manifold

MF:  
For mounting on manifold  
(Note) A gasket & two  
mounting screws come  
with valve.

## Wiring

No mark: Without connector

E : Connector with wire  
(Length: 500 mm)

## Port size 2, 4

M5: M5

## Wiring withdrawal direction

**P:**  
With indicator light and  
surge suppressor

**S:**  
Without indicator light  
and surge suppressor

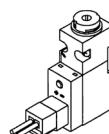
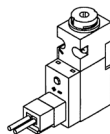

## Voltage

- 1: DC24V
- 2: \*DC12V
- 3: \*DC6V
- 4: \*DC5V
- 5: DC3V
- 7: AC100V
- 8: AC110V



\*: Made to order

## Connector with lead wire

**A 0 5 P — D C — C L 5**

### Type

P: For PR type

### Lead wire length

5 : 500mm

10: ※1000mm

### Voltage

DC: For DC

AC: For AC type

### For PR type

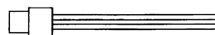

(For common use with PR type of A05, A12, and A20)

	DC	AC
(+)	Black	Blue
(-)	Red	Blue

## Tag for solenoid valve

**A 0 5 P — N (Pack of 10)**

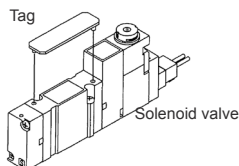

(For common use with sub-base mounting type of A05, A12, and A20)

## Base gasket

**A 0 5 P X — G**

### Special Specifications

No mark: Standard  
X : For external pilot (with port X)

### Content of kit

SG: Gasket & mounting screws  
G : Only gasket (Pack of 10)  
S : Only mounting screw (Pack of 20)

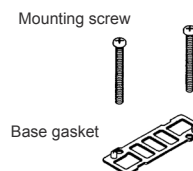

(For common use with A05P)

## Blank plate

For A05P

**A 0 5 P — B P**

Mounting screw

Blank plate

Base gasket

(For common use with A05G)

For A05R

**A 0 5 R — B P**

Mounting screw

Blank plate

Manifold gasket

(For common use with A05F)

## Base gasket

**A 0 5 R — G**

### Content of kit

SG: Gasket & mounting screws

G : Only gasket (Pack of 10)

S : Only mounting screw (Pack of 20)

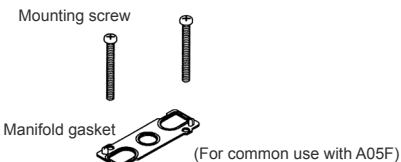

(For common use with A05F)

## Locking cover

**A 0 5 P — L A**



(For common use with all A05, A12, and A20)

### Color

A: Orange



※: Made to order

MFC□-A05P-M5

(Unit: mm)

Manual locking cover

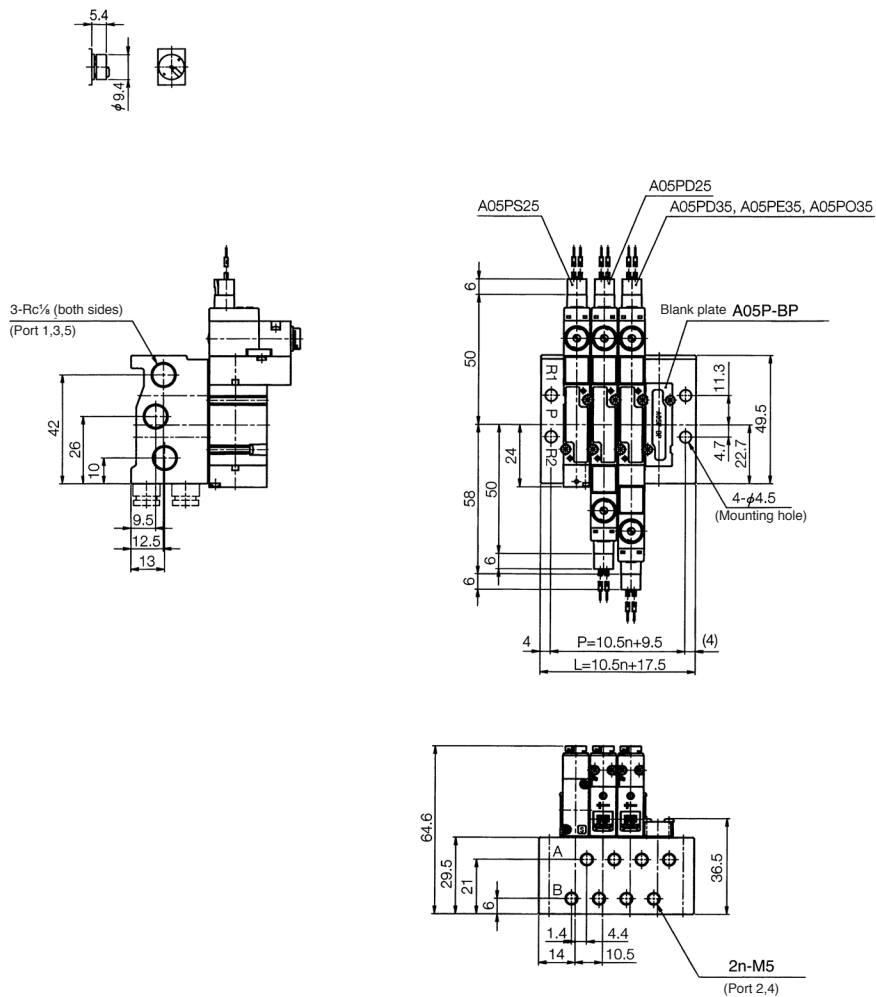

MFC□-A05P-M5-B

(Unit: mm)

## Manual locking cover

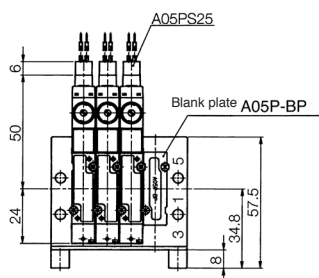
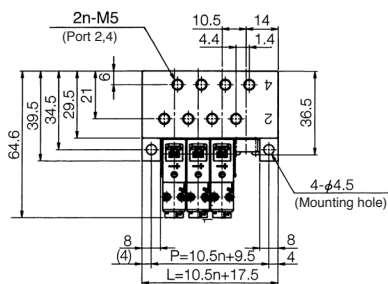
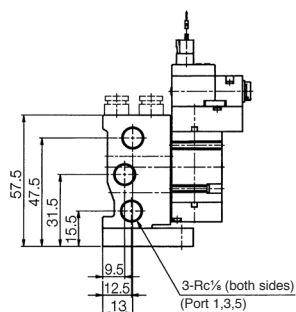
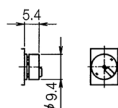

MFS□-A05P-01, MFX□-A05P-01

(Unit: mm)

## Manual locking cover

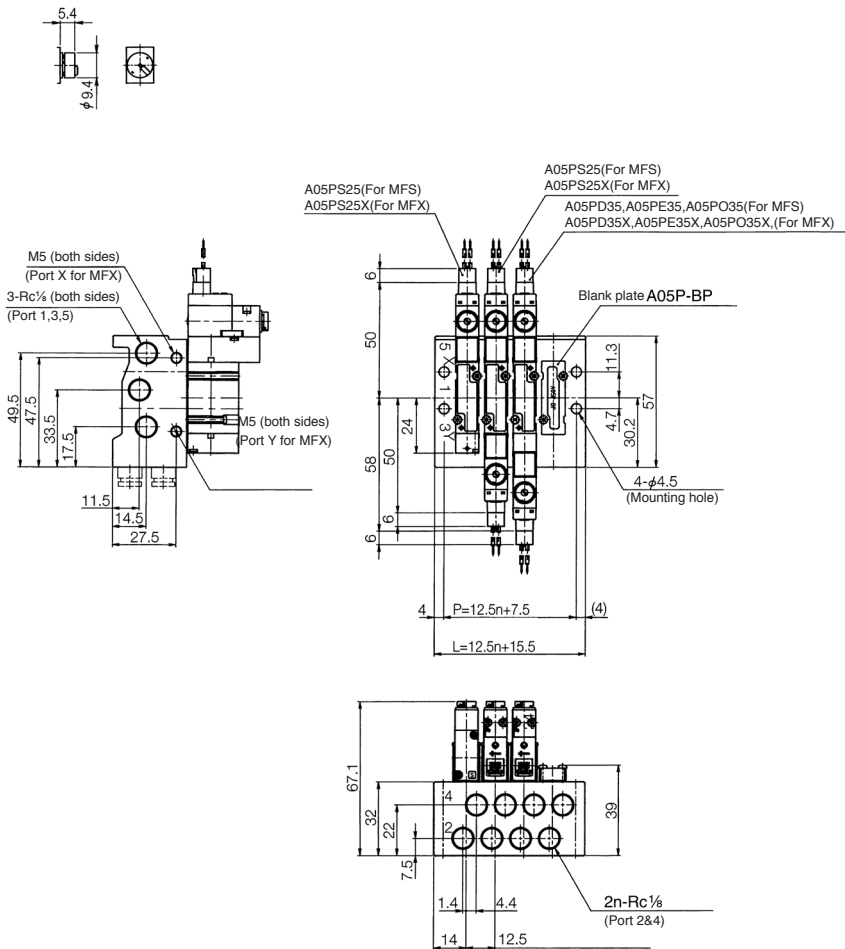

MFS□-A05P-01-B

(Unit: mm)

### Manual locking cover

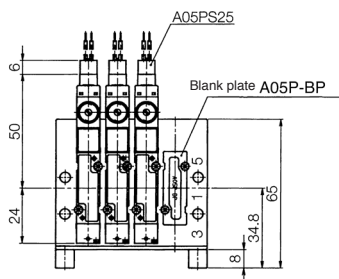
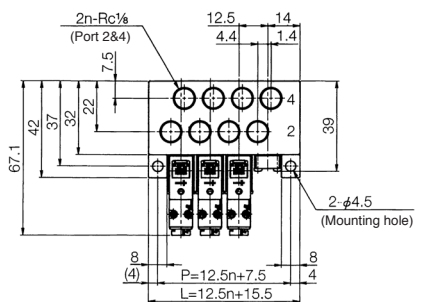
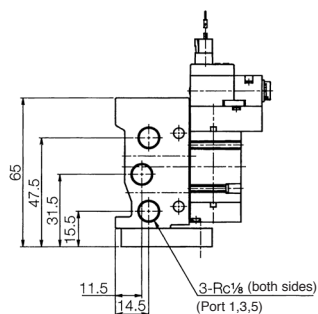
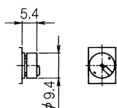



MFU□-A05R-M5

(Unit: mm)

## Manual locking cover

