

ADEX A20R Series

5 Port Pilot Operated Solenoid Valve
Rubber Seal/Sub-base Mounting type

A20RS25

2-position, single solenoid

A20RD25

2-position, double solenoid

A20RD35

3-position, closed center

A20RE35

3-position, ABR connect

A20RO35

3-position, PAB connect



Specifications

Model No.			Unit	A20RS25	A20RD25	A20RD35	A20RE35	A20RO35
Fluid				Non-lubricated/lubricated air				
Port size				port 1,2,4: RC $\frac{1}{4}$		port 3,5: RC $\frac{1}{2}$		
Effective area			mm ²	17.6		15.7		18.1
Cv value				0.97		0.86		1.00
Operating ambient temperature			°C	-5~50				
Pressure range			MPa	0.15~0.7	0.1~0.7	0.2~0.7		
				-0.1~0.7 For external pilot operation				
Maximum Frequency			cycle/min	300		200		
Response Time	DC	ON	s	0.018	0.010	0.015		
		OFF	s	0.028 (0.034)	—	0.060 (0.066)		
	AC	ON	s	0.021	0.013	0.018		
		OFF	s	0.034	—	0.065		
Pilot air exhaust				Individual exhaust				
Manual override				Screw driver-operated locking button				
Mounting position				Free				
Shock resistance, vibration resistance			m/s ²	150/30				
Weight			g	114	133	141		



- Service kit not available
- Supply complete-dry air to avoid freezing when temperature of valve site falls below 5°C
- Pressure range of external pilot supply: 0.25~0.7MPa
- Response time in bracket () is displayed with surge suppressor
- Response time shown above is in accordance with JIB B 8375
- Effective area shown above is a value between ports 1 and 2, 4

Electrical Specifications

Rated voltage		DC	V	24, 12, 6, 5, 3
		AC	V	100, 110 (50/60Hz)
Permissible voltage fluctuation			%	+10, -10
Power consumption	DC		W	0.6 (with indicator light and surge suppressor), 0.55 (without indicator light and surge suppressor)
	AC	110V	VA	1.4 (with indicator light and surge suppressor), 1.3 (without indicator light and surge suppressor)
Grade of Insulation				JIS grade E
Wiring				Plug-in connector
Surge suppressor				Diode
Indicator light				LED

A20R S25 — **1 P** — **02** — **E**

Switch Form

S25

2-position, single solenoid

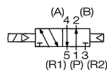

D25

2-position, double solenoid

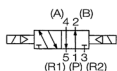

D35

3-position, closed center

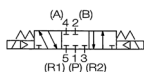

E35

3-position, ABR connect

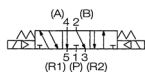

O35

3-position, PAB connect

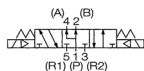

Special Specification

No mark : standard

(Internal pilot)

X : ※External pilot

Voltage

1: DC24V

2: ※DC12V

3: ※DC6V

4: ※DC5V

5: ※DC3V

7: ※AC100V

8: AC110V

Wiring

No mark: Without connector

E : Connector with wire
(Length: 500 mm)

Port size 2, 4

02: Rc $\frac{1}{4}$

(Note) when using G, NPT, NPTF, please consult FONTAL first

Wiring withdrawal direction

P:

With indicator light and surge suppressor

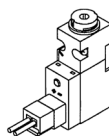

S:

Without indicator light and surge suppressor

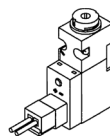

Q:

With indicator light and surge suppressor

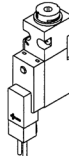

B:

With indicator light and surge suppressor

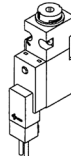

※: Made to order

Connector with lead wire

A 0 5 P — D C — C L 5

Type

P: For PR type

Lead wire length

5 : 500mm
10: ※1000mm

Voltage

DC: For DC
AC: For AC type

For PR type

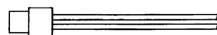

	DC	AC
(+)	Black	Blue
(-)	Red	Blue

(For common use with PR type of A05, A12, and A20)

Locking cover

A 0 5 P — L A



Color

A: Orange

(For common use with all
A05, A12, and A20)

Bracket

A 2 0 R — B F

Bracket

F: Foot Bracket
S: Side bracket

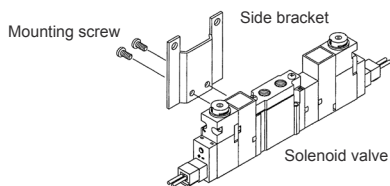
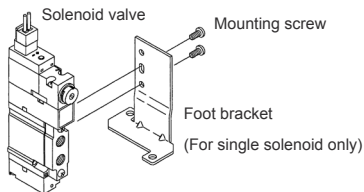

Note: Gasket(s) and mounting screws are provided
(For common use with A20F)

◎ 2-position Single solenoid

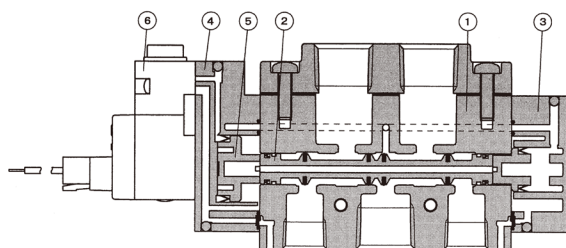

◎ 2-position Double solenoid

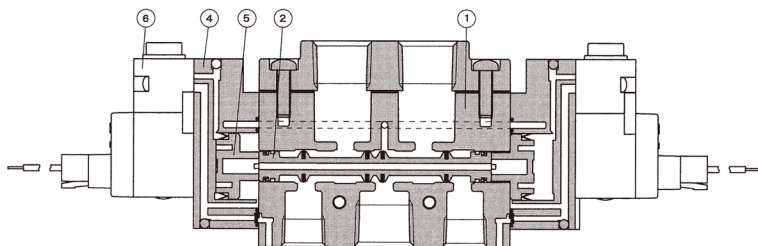

◎ 3-position Closed center
3-position ABR connect
3-position PAB connect

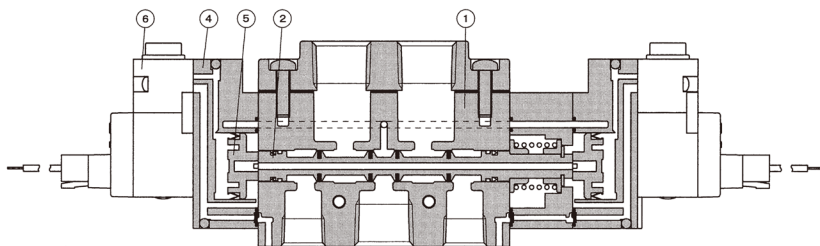

Main Component

No.	Description	Material
1	Body	Zinc die-casting
2	Spool assembly	Aluminium alloy/NBR
3	End cover	Resin
4	Piston head	Resin
5	Piston	Resin
6	Pilot valve	Refer to A00 Series

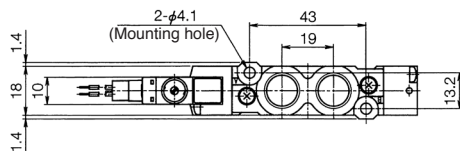

**Connector position:
P or S**

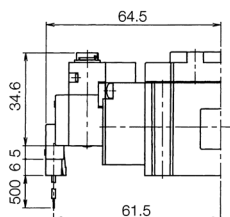
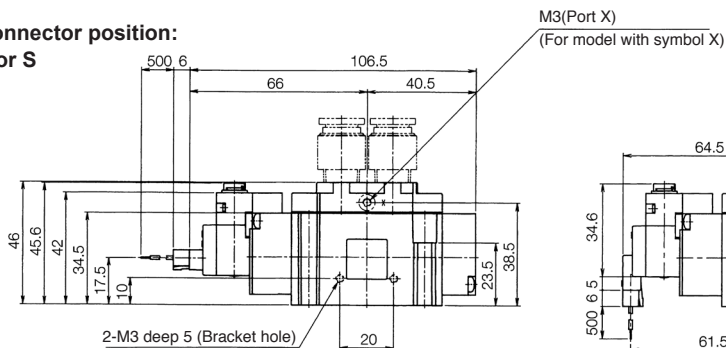

**Connector position:
Q or B**

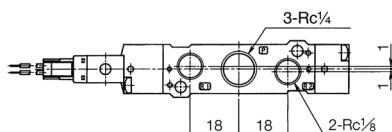

Manual locking cover

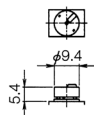

Foot bracket

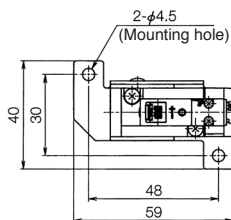

Side bracket

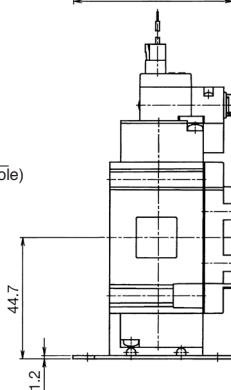
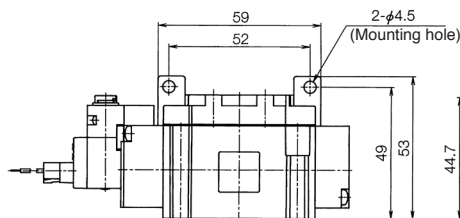
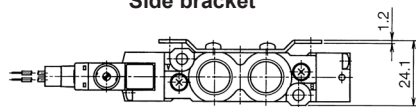

A20RD25

(Unit: mm)

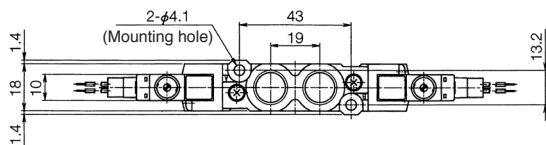

**Connector position:
P or S**

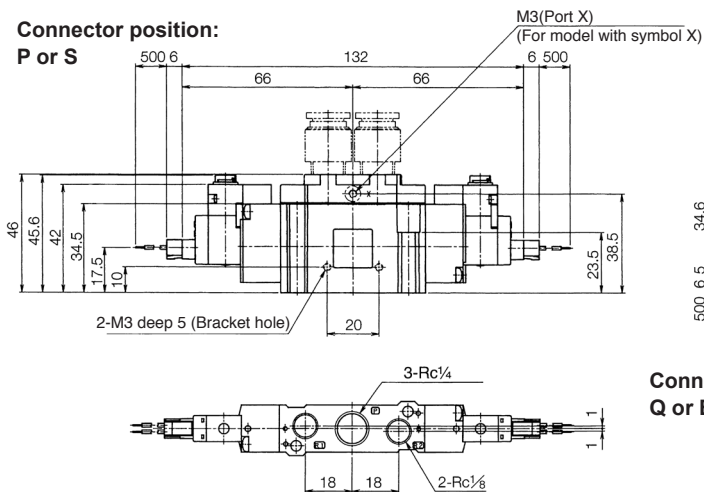

**Connector position:
Q or B**

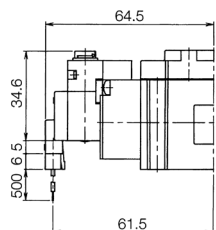

Manual locking cover

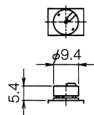

Side bracket

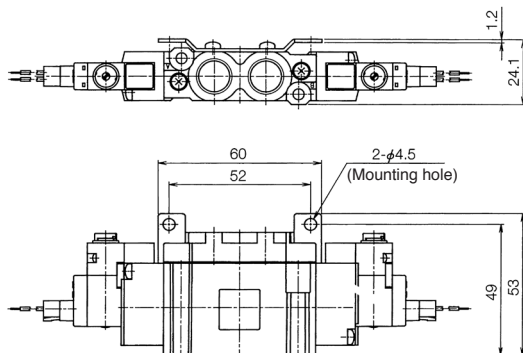

A20RD35, A20RE35, A20RO35

(Unit: mm)

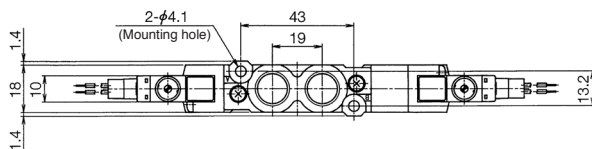

Connector position:

P or S

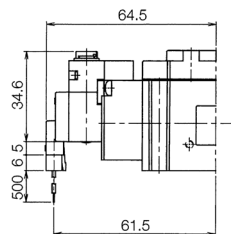
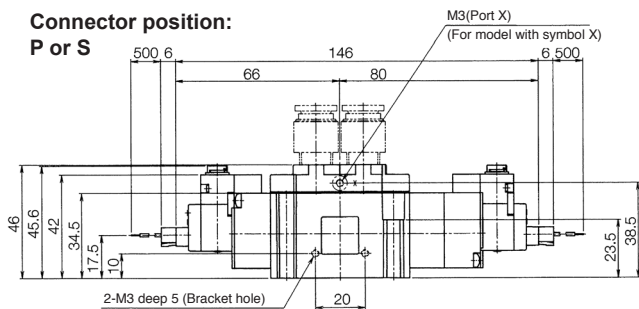

Connector position:

Q or B

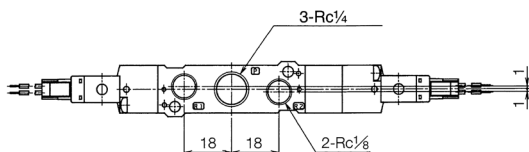

Manual locking cover

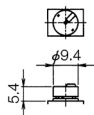

Side bracket

