

ADEX MFO-A12G, A12F

Individual Wiring Type Manifold
Bar Type

MFS□-A12G

Common SUP, common exhaust,
ports 2 & 4 on the side

MFX□-A12G

Common SUP, common exhaust,
common external pilot, ports 2 & 4
on the side

MFU□-A12F

Common SUP, common exhaust,
ports 2 & 4 on the valve body

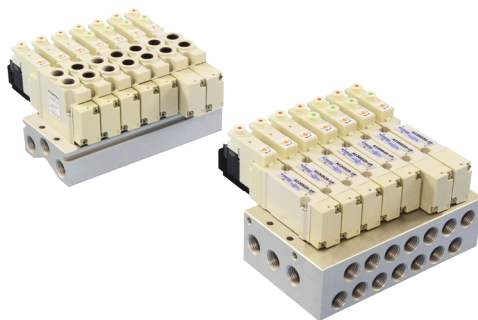

Manifold Specifications

		For A12G Series		For A12F Series
		MFS□-A12G	MFX□-A12G	MFU□-A12F
Type of manifold		Common SUP, common exhaust, pilot valve captured exhaust, ports 2 & 4 on the side	Common SUP, common exhaust, common external pilot, pilot valve captured exhaust, ports 2 & 4 on the side	Common SUP, common exhaust, pilot valve captured exhaust, ports 2 & 4 on the valve body
Port size	Ports 1, 3, 5	Rc $\frac{1}{4}$	Rc $\frac{1}{4}$	Rc $\frac{1}{4}$
	Ports 2, 4	Rc $\frac{1}{4}$	Rc $\frac{1}{4}$	Rc $\frac{3}{8}$
	Port Y	—	M5	—
	Port X	—	M5	—
Number of stations		2~20		
Installation		Direct mount		
Mountable solenoid valve		A12GS25 A12GD25 A12GD35 A12GE35 A12GO35	A12GS25X A12GD25X A12GD35X A12GE35X A12GO35X	A12FS25 A12FD25 A12FD35 A12FE35 A12FO35
Blank plate		A12P-BP		A12R-BP



Tagging method

- Specify the type and number of manifolds and solenoid valves, as well as number of blank plate if needed.

Manifold for A12G Series



Type of manifold

MFS:
Common SUP, common exhaust, ports 2 & 4 on the side
MF:
Common SUP, common exhaust, common external pilot, ports 2 & 4 on the side

Mountable solenoid valve series
A12G

Port size 2, 4

02: Rc1/4
(Note) when using G, NPT, NPTF tag, please consult FONTAL first

Number of stations

2 : 2 station
... : ...
20 : 20 station

Mountable solenoid valve

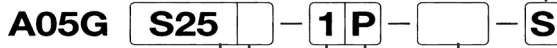

Switch Form

S25

2-position, single solenoid

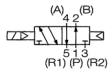

D25

2-position, double solenoid

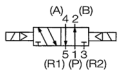

D35

3-position, closed center

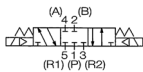

E35

3-position, ABR connect

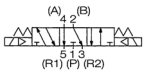

O35

3-position, PAB connect

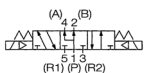

Wiring

No mark: Without connector
S : Connector with lead wire for single solenoid (Length: 500 mm)
D : Connector with lead wire for double solenoid (Length: 500 mm)

Port size

No mark: Without sub-base
(A gasket & two mounting screws come with a valve)

Wiring withdrawal direction

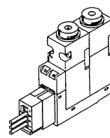

NPN type

P: With indicator light and surge suppressor
S: Without indicator light and surge suppressor

PNP type

※M: With indicator light and surge suppressor
※J: Without indicator light and surge suppressor

Voltage

- 1: DC24V
- 2: ※DC12V
- 3: ※DC6V
- 4: ※DC5V
- 5: ※DC3V

☰ ※ : Made to order

Special Specifications

No mark: Standard
X: For external pilot (with port X)

Manifold for A12F Series

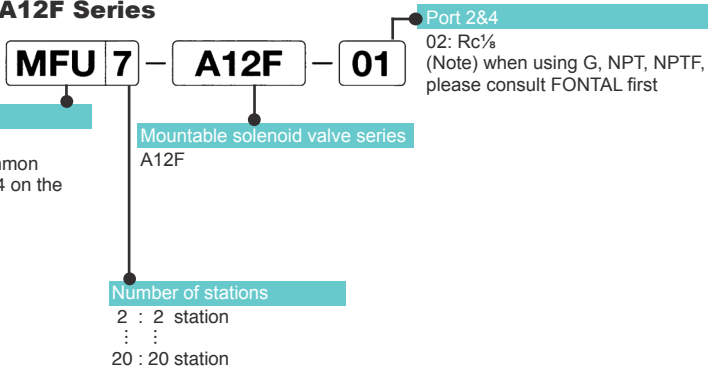

Mountable solenoid valve

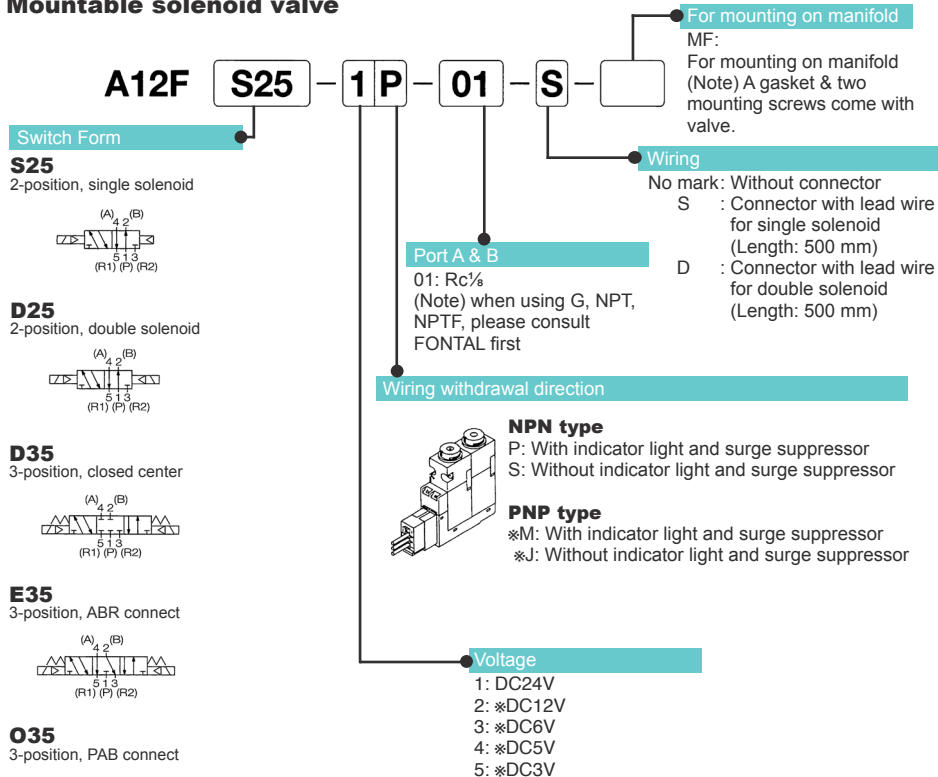

* : Made to order

Connector with lead wire

A 0 5 G S - D C - C L 5 - M

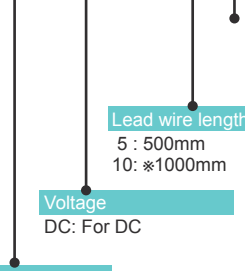

Type
GS : For GF type single solenoid
GD : For GF type double solenoid

For GF type single solenoid



For GF type double solenoid



(For common use with GF type of A05, A12, and A20)

Locking cover

A 0 5 P - L A



Color
A: Orange (For solenoid A side)
B: Green (For solenoid B side)

(For common use with all A05, A12, and A20)

Tag for solenoid valve

A 0 5 P - N (Pack of 10)

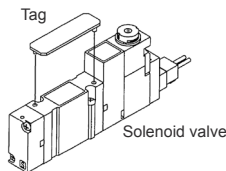

(For common use with sub-base mounting type of A05, A12, and A20)

Blank plate

For A12G

A 1 2 P - B P

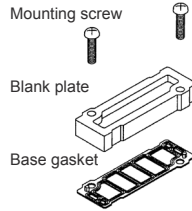

(For common use with A12P)

For A12F

A 1 2 R - B P

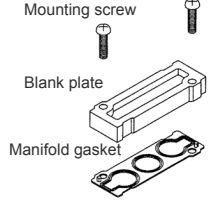

(For common use with A12R)

Manifold gasket

A 1 2 R - G

Content of kit
SG: Gasket & mounting screws
G : Only gasket (Pack of 10)
S : Only mounting screw (Pack of 20)

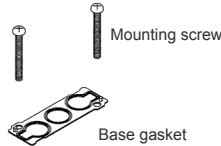

(For common use with A12R)

Base gasket

A 1 2 P X - G

Special Specifications

No mark: Standard
X : For external pilot (with port X)

Content of kit

SG: Gasket & mounting screws
G : Only gasket (Pack of 10)
S : Only mounting screw (Pack of 20)

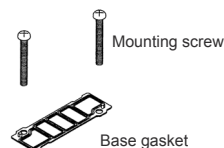

(For common use with A12P)

※: Made to order

MFS□-A12G-02, MFX□-A12G-02

(Unit: mm)

Manual locking cover

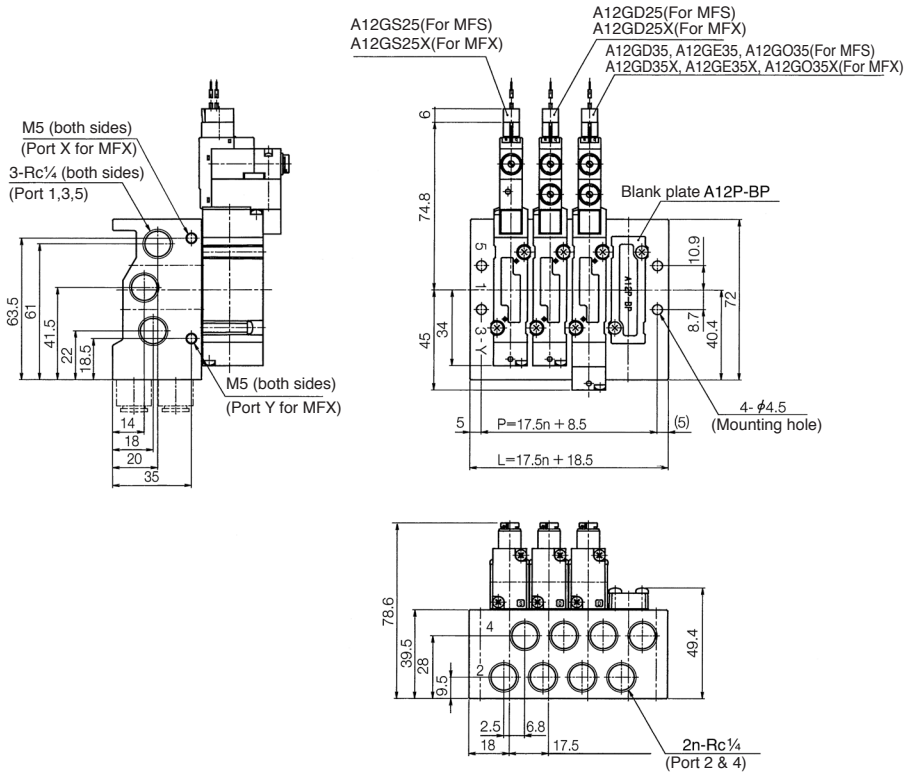
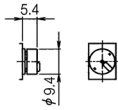

MFU□-A12F-01

(Unit: mm)

Manual locking cover

